

WXP™ HYDRATION SYSTEM

USE AND CARE INSTRUCTIONS

TACTICAL 2L/70oz
3L/100oz



www.source-military.com

Did you know?

(a short course on hydration and dehydration)

Water is essential: Water is essential even if you are just breathing, but when exercising it is especially vital. During prolonged or strenuous exercise you can easily sweat away over 1 liter of water an hour. You must drink to replenish that sweat loss.

You are what you drink: Dehydration = Amount you drink < Water loss from sweating.

Even slight dehydration can cause fatigue, dizziness, reduced muscle endurance, headaches and cramps. In fact, prolonged dehydration is downright dangerous to your health!

The cooler, the better: Your body's system of fluid replacement works better if the liquid you drink is cooler (15-22°C or 59-72°F).

The faster, the better: Reducing the gap between the time you lose water and replenish water loss ensures that your body has all the water it needs to function at peak level. Quick, easy access to a reliable, refreshing source of H₂O is the key.

As a rule: Your body needs 1 liter (33 oz) of water for every hour of intensive outdoor activity.

Why your drinking water should be obtained from a highly reliable Source.

Bacteria, molds, yeasts and algae are facts of life; however they can endanger your life when rapidly growing and dividing in a medium such as drinking water. Bacteria grow by clinging to a surface and creating a bio-film that allows them to flourish and become potentially dangerous. A liquid container with a smooth contact surface such as glass reduces the ability of bio-film to form. There are no irregularities on the surface for bacteria to cling to and the regular flow of water self-cleans the container.

Source has developed a unique plastic film that has a Glass-Like™ surface.

No other plastic film has such characteristics.

On top of that, Source has innovated Grunge-Guard™, a unique anti-microbial technology, and integrated it into all films and tubes. Grunge-Guard™ utilizes an FDA approved agent that blocks bacteria growth on the tube and reservoir surfaces. Grunge-Guard™ has no effect on the water and will not leach into the water. The synergy of Glass-Like™ and Grunge-Guard™ gives double protection against bacteria growth. Your drinking water stays fresh, odor and taste-free for days, even weeks! No need to clean. Simply refill and drink again and again.

Fitting on Back

Fit pack when reservoir is filled.

1. Mount pack on back and adjust shoulder straps until pack is stable (pull straps to tighten, or lift buckles to release).
2. To keep loose strap-ends from dangling, roll strap-ends and insert under elastic Securend™ loops. (Fig A).
3. Snap sternum strap buckle (Fig B) and pull strap to tighten until comfortable (Fig C). Adjust height of sternum strap to maintain best position by sliding glide buckles up or down on shoulder straps (Fig D).
4. Adjust tube length by sliding extra tubing back inside pack (Fig E).
5. Fix tube or mouthpiece on the shoulder strap using the Velcro fastener (Fig F).

Tip: You may route the drinking tube through the right or left shoulder strap.

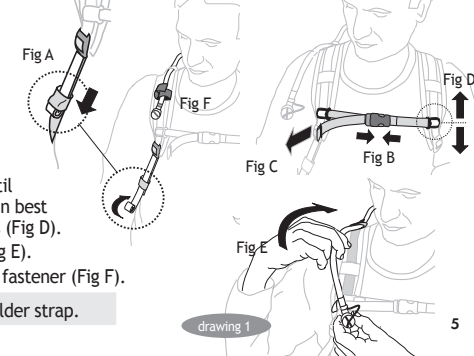

drawing 1

Fitting on Gear

1. Unclip Quick-Release shoulder strap buckles.
2. Fold shoulder straps and stow into back pocket (drawing 2).
3. Load into a larger pack or use QCA™ system (Quick-Connect Attachment) to mount pack on gear.
4. For Quick-Connect Attachment, thread male buckle through any loop on gear (Fig A), snap into QCA™ female buckle (Fig B) and tighten (Fig C).
5. Pull all straps to tighten until pack is stable (drawing 3).

Fig A



Fig B



Fig C

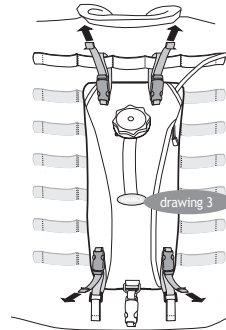

Filling

1. Open Filler-Cap.
2. Grasp integrated Refill-Handle and fill reservoir (drawing 4).
The reservoir is designed to store cold as well as warm drinks (up to 60°C or 140°F). You may add ice for cold drinks, or even freeze water in the reservoir overnight (only 3/4 full).
3. Close Filler-Cap and tighten for airtight seal.

Caution: Do not fill with boiling water.

Tip: Turn pack upside down and suck out excess air from the reservoir. This significantly increases the period for which water remains fresh and taste-free, and reduces the volume of the pack. It also prevents liquid from splashing, so it silences your pack (stealth mode).

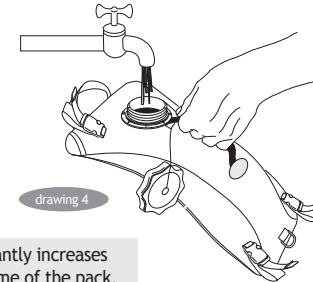

Drinking

First time use: Remove hygienic shrink-wrap from Storm-Valve™.

1. Remove Dirt-Shield™ protective cover.
2. Unlock valve from shut-off position by turning mouthpiece 90° counter-clockwise.
3. Open valve by pulling rubber mouthpiece with teeth and sip.
4. To close valve, push in mouthpiece.
5. To lock valve when closed, turn mouthpiece 90° clockwise (drawing 5).

Note: *In the lock/shut-off position, the grooves on the rubber mouthpiece are aligned with the dots on the valve's housing. In the dark, use your fingers to verify that the valve is in the secure lock position.*

- Tips:**
- ▶ To keep the mouthpiece clean and protected when not in use, simply put the Dirt-Shield™ protective cover on the Storm-Valve™.
 - ▶ Pull/Push Valve can be operated by hand or by mouth.

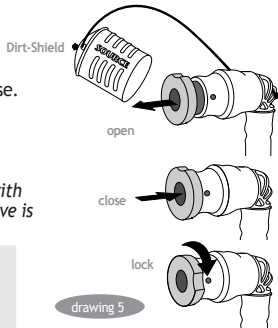

Care

During regular use with drinking water, there is no need to drain, dry, or clean your hydration system. Simply refill and drink again and again without special care. As long as your drinking water is not exposed to direct sunlight, the same water in your drinking system will remain fresh for days and even weeks. If you are using energy drinks or sweetened liquids, we recommend that you follow the cleaning instructions after use.

To Dry Drinking System:

1. Open pack's top zipper to expose Widepac™ closure.
2. Open reservoir by sliding Widepac™ closure off sideways and unfolding top (drawing 6).
3. Drain completely and hang pack upside down to dry. You can use the D-Ring at the bottom of the pack for hanging. To speed up drying time, open Filler-Cap and Storm-Valve™. You may also use paper towels to dry reservoir.
4. When completely dry, fold top and close reservoir's wide opening by sliding back the Widepac™ closure (drawing 7).

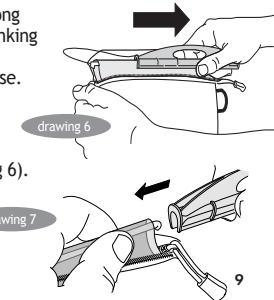

To Store Drinking System:

1. Dry drinking system (see page 9) and store with Filler-Cap open, in a clean and dry place.

Note: Before prolonged storage, we recommend that you also follow the cleaning instructions.

Tip: After prolonged storage, rinse reservoir with water and a few drops of lemon juice.

To Replace Drinking System: (converting from a regular to a SOURCE NBC drinking system or replacing the old drinking system with a new one)

1. Free drinking tube from the fastener on shoulder strap and open Filler-Cap.
2. Unscrew tightening ring (drawing 8) and free nozzle by pushing it inward (drawing 9).
3. Open top or side zipper and pull drinking system reservoir out of pack*.
4. Install by performing steps 1-3 in reverse order.

Attention: Always make sure the tightening ring (to which the cord securing the cap is attached) is *fully tightened* - when the cord base on the ring points 5 o'clock on the pack (drawing 8)

* some TACTICAL models have only a top zipper.

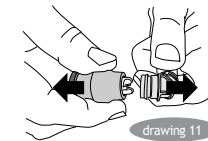
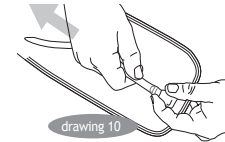
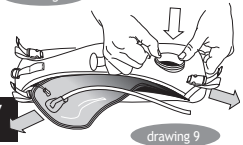
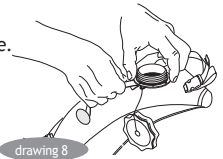

To Clean Drinking System:

1. Remove drinking system from pack (see To Replace Drinking System).
2. Disassemble drinking system by firmly pulling and twisting tube (drawing 10) and Storm-Valve™ (drawing 11) from their fittings.
3. Slide off Widepac™ closure for access to wide opening (drawing 12).
4. Wash out reservoir, tube, and valve with soapy water .
Scrub with a soft cloth, if necessary. Rinse well.

Caution: Never use boiling water. Do not scrub reservoir with abrasive materials.

5. Dry reservoir, tube, and Storm-Valve™ completely.
6. Reassemble tube, Storm-Valve™ and Widepac™ closure in reverse order to steps 2-3.

Tip: Occasionally place reservoir, tube, and valve in the freezer to kill any existing microorganisms. After freezing, thaw and rinse reservoir thoroughly.



Secondary Disassembly of Storm-Valve™

This should be performed only if Storm-Valve™ is severely soiled.

To Disassemble Storm-Valve™:

1. Remove Storm-Valve™ from angled valve-tube fitting (drawing 11, page 11)
2. Set Storm-Valve™ to closed/locked position (with the grooves on the mouthpiece aligned with the dots on the housing).
3. Press clip ends of mouthpiece together (drawing 13) and push mouthpiece away from its housing.

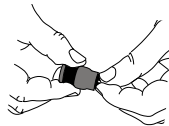

drawing 13

To Reassemble Storm-Valve™:

1. Align the two clip ends of the mouthpiece with the dots on the housing and insert the mouthpiece firmly (the two clip ends are forced inward by the smaller opening on the housing) (drawing 14).
2. Push mouthpiece all the way inward until it clicks into place (the mouthpiece is in the closed/locked position).

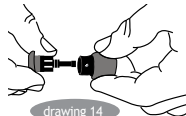

drawing 14